

IMPORTANT SAFETY PRECAUTIONS

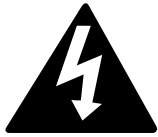

CAUTION
RISK OF ELECTRIC SHOCK
DO NOT OPEN



CAUTION: TO REDUCE THE RISK OF ELECTRIC SHOCK, DO NOT REMOVE COVER (OR BACK). NO USER-SERVICEABLE PARTS INSIDE. REFER SERVICING TO QUALIFIED SERVICE PERSONNEL.



DANGEROUS VOLTAGE
Uninsulated Dangerous Voltage, that may be of sufficient magnitude to constitute a risk of electric shock to persons is present within this product's enclosure.



ATTENTION
The Owner's Manual contains important operating and maintenance instructions.
For your safety, it is necessary to refer to the manual.

INSTALLATION INSTRUCTION PRECAUTIONS:

- Never install telephone wiring during a lightning storm.
- Never install telephone jacks in wet locations unless the jack is specifically designed for wet locations.
- Never touch uninsulated telephone wires or terminals unless the telephone line has been disconnected at the network interface.
- Use caution when installing or modifying telephone lines.

When using your telephone equipment, basic safety precautions must always be followed to reduce the risk of fire, electric shock and injury to persons, including the following:

1. Read and understand all instructions.
2. Follow all warnings and instructions marked on this product.
3. Unplug this product from the wall outlet before cleaning. Do not use liquid cleaners or aerosol cleaners. Use a damp cloth for cleaning.
4. Do not use this product near water- for example, near a bathtub, washbowl, kitchen sink, or laundry tub, in a wet basement, or near a swimming pool.
5. Do not place this product on an unstable cart, stand, tripod, bracket, or table. The product may fall, causing serious injury and serious damage to the product.
6. Slots and openings in the cabinet and in the back or bottom are provided for ventilation and to ensure reliable operation of the product and to protect it from overheating. These openings must not be blocked or covered. The openings should never be blocked by placing the product on a bed, sofa, rug, or other similar surface. This product should never be placed near or over a radiator or heat source. This product should not be placed in an enclosed environment unless proper ventilation is provided.
7. Do not allow anything to rest on the power cord. Do not locate this product where the cord will be abused by persons walking on it.

IMPORTANT SAFETY PRECAUTIONS (CONTINUED)

8. Do not overload wall outlets and extension cords as this can result in the risk of fire or electric shock.
9. Never push objects of any kind into this product through openings as they may touch dangerous voltage points or short out parts that could result in fire or electric shock. Never spill or spray any type of liquid on the product.
10. To reduce the risk of electric shock, do not disassemble this product, but take it to a qualified serviceman when some service or repair work is required. Opening or removing covers may expose you to dangerous voltages or other risks. Incorrect re-assembly can cause electric shock when the appliance is subsequently used.
11. Unplug the product from the wall outlet and refer servicing to qualified service personnel under the following conditions:
 - a. When the power-supply cord or plug is damaged or frayed.
 - b. If liquid has been spilled into the product.
 - c. If the product has been exposed to rain or water.
 - d. If the product does not operate normally by following the operating instructions. Adjust only those controls that are covered by the operating instructions, as an adjustment of other controls may result in damage and will often require extensive work by a qualified technician to restore the product to its normal operation.
 - e. If the product has been dropped or the cabinet has been damaged.
 - f. If the product exhibits a distinct change in performance.
12. Avoid using a telephone (other than a cordless type) during an electrical storm. There may be a remote risk of electric shock from lightning.
13. Do not use the telephone to report a gas leak near the leak.

SAVE THESE INSTRUCTIONS

BATTERY PRECAUTIONS

To reduce the risk of fire or injury to persons, read and follow these instructions:

1. Use only the battery pack type provided with the unit.
2. Do not dispose of the battery in a fire, the cell may explode. Check with local codes for possible special disposal instructions.
3. Do not open or mutilate the battery as released electrolyte is corrosive and may cause damage to the eyes or skin. It may be toxic if swallowed.
4. Exercise care in handling the battery in order not to short the battery with conducting material such as rings, bracelets and keys. The battery or conductors may overheat and cause burns.
5. Recharge only the battery provided with or identified for use with this product. The battery may leak corrosive electrolyte or explode if it is not the correct type.
6. Do not attempt to rejuvenate the battery provided with or identified for use with this product by heating them. Sudden release of the battery electrolyte may occur causing burns or irritation to eyes or skin.
7. When inserting the battery into this product, the proper polarity or direction must be observed. Reverse insertion of the batteries can cause charging that may result in leakage or explosion.

IMPORTANT SAFETY PRECAUTIONS (CONTINUED)

- 8. Do not store this product, or the battery provided with or identified for use with this product, in a high-temperature area. Batteries that are stored in a freezer or refrigerator for the purpose of extending shelf life should be stabilized at room temperature prior to use after cold storage.
- 9. Disconnect telephone lines before installing batteries.

FCC and Phone Company Information

Your telephone company is required by the Federal Communications Commission to allow you to connect FCC registered telephones to their lines. The FCC requires you to provide information, if requested by the local telephone company, about the connection of an FCC registered telephone to their lines. They may ask you for the FCC registration number and the ringer equivalence number (REN); both are at the bottom of the base. They may also ask for the Universal Service Order Code (USOC), which is the RJ-11C.

The REN is used to determine the quantity of devices which may be connected to the telephone line. Excessive REN's on the telephone line may result in the devices not ringing in response to an incoming call. In most, but not all areas, the sum of the REN's should not exceed five (5.0). To be certain of the number of devices that may be connected to the line, as determined by the total REN's, contact the telephone company to determine the maximum REN for the calling area.

Should your equipment cause trouble on your line which may harm the telephone network, the telephone company shall, where practical, notify you that temporary discontinuance of service may be required. Where prior notice is not practicable and the circumstances warrant such action, the telephone company may temporarily discontinue service immediately. In case of such temporary discontinuance, the telephone company must: (1) promptly notify you of such temporary discontinuance; (2) afford you the opportunity to correct the situation; (3) inform you of your right to bring a complaint to the Commission pursuant to procedures set forth in of Part 68 of FCC Rules and Regulations.

The telephone company may make changes in its communication facilities, equipment operations or procedures where such action is required in the operation of its business and not consistent with FCC Rules and Regulations. If these changes are expected to affect the use of performance of your telephone equipment, the telephone company must give you adequate notice in writing, to allow you to maintain uninterrupted service. This equipment cannot be used on telephone company provided coin service.

Connection to Party Line Service is subject to state tariffs.

Any changes or modifications not expressly approved by (state party responsible for compliance) can void the user's authority to operate the equipment.

BATTERY DISPOSAL: This battery must be disposed of properly.



CONTENTS

- Important Safety Instructions**.....1
- Contents**4
- Location of Controls**.....5
- Installation Instructions**6
 - Connecting the Headset6
 - Installation of the Rechargeable Battery.....7
 - Charging the Rechargeable Battery7
- Set-Up Instructions**.....8
 - Setting the Time8
 - Setting the Area Codes9
 - Changing the Handset's Volume10
 - Changing the Ringer Volume11
 - Setting the Contrast11
 - Changing the Ringer Melody12
- Advanced Features**.....13
 - Registering the Handsets13
 - Assigning/Changing Handset's Internal/Intercom Number14
 - Setting the Alarm15
 - Turning the Alarm On/Off16
 - Setting the Alarm Melody17
 - Setting the Alarm Volume17
 - Making Intercom Calls18
 - Paging All Handsets.....18
 - Ending an Intercom Call18
 - Transferring a Call19
 - Three Way Conference Calling.....19
- Troubleshooting Guide**20
- Care and Maintenance**.....21

FOR BASIC OPERATION, REFER TO THE MANUAL THAT CAME WITH THE MAIN BASE (MCD4300BT).

LOCATION OF CONTROLS

FRONT

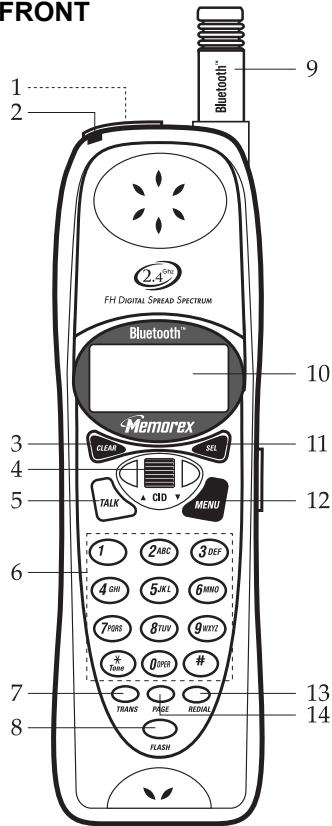

HANDSET:

1. Headset Jack (top of handset)
2. Handset LED Indicator
3. CLEAR Button
4. CID JOG Control
5. TALK Button
6. Key buttons (0-9, *, #)
7. TRANS (Transfer) Button
8. FLASH Button
9. Handset Antenna
10. Display
11. SEL (Select) Button
12. MENU Button
13. REDIAL Button
14. PAGE Button

BASE

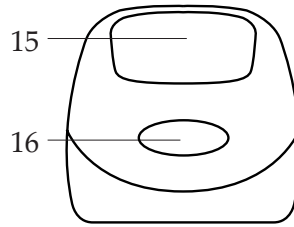

BASE:

15. Charger
16. Base LED Indicator

All logo marks are trademarks of their respective company.

DISPLAY (CHECKING CALLER ID)

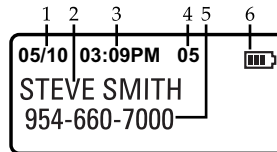

DISPLAY (STANDBY MODE)

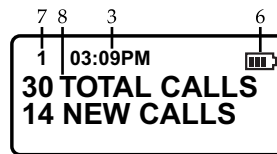

DISPLAY:

- | | |
|-------------------|----------------------|
| 1. Date | 5. Number of Caller |
| 2. Name of Caller | 6. Battery Indicator |
| 3. Time | 7. Extension Number |
| 4. Caller Number | 8. Total/New Calls |

INSTALLATION INSTRUCTIONS

1. Carefully unpack and remove your unit from the box.
2. Make sure all the items have been included:
 - Charger Unit
 - Handset Unit
 - Rechargeable Ni-MH battery pack
 - Belt Clip
3. Make sure the Rechargeable Battery is installed or install the Rechargeable Battery as described on the next page.
4. Plug the AC adapter into a standard 120V AC wall outlet.

Connecting the Headset (Not Supplied)

Insert the headset plug into the Headset jack on the top of the handset. To answer a call, simply press the TALK button. To end the call, press the TALK button again.

INSTALLATION INSTRUCTIONS (CONTINUED)

Installation of the Rechargeable Battery

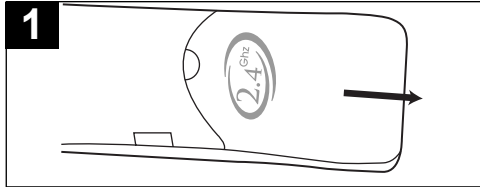

1 Remove the battery cover located on the rear of the handset by sliding it downward.

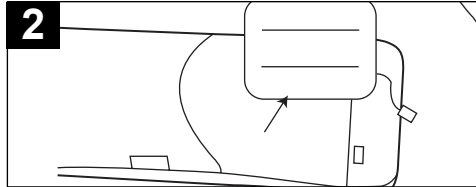

2 If replacing an old battery pack, unplug the battery connector and remove it by carefully using a small flat head screwdriver to pry it out from the battery compartment.

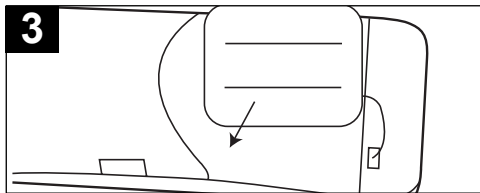

3 Plug the new battery into the rechargeable battery plug and insert the rechargeable battery into the battery compartment. Make sure cable connector is inserted into the slot correctly and securely.

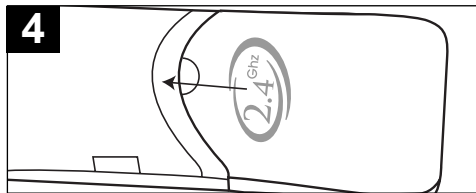

4 Put the battery cover back on by sliding it upward until it clicks in place.

Charging the Rechargeable Battery

It is recommended that the rechargeable battery be fully charged overnight prior to initial use. The handset's rechargeable battery will be charged when it's on the base's charge contacts; the Base LED indicator will light.

The battery low indicator will light in the display and a beep will be heard when using the handset and the battery power is low and needs recharging.

NOTES:

- If the battery does not appear to be charging please insure the cable connector of the battery is inserted correctly and securely. The display will still read "Charging" and the base LED will light up as long as the contacts of the phone and base are touching even if the battery is not properly connected so this does not insure proper charging.
- Every few months, or when charging becomes abnormal, clean the contacts of the handset and the base with a standard pencil eraser.

SET-UP INSTRUCTIONS

SETTING THE TIME

It may be necessary to set the internal clock time of the phone to display the time in the Caller ID display when incoming calls are received. **If you subscribe to Caller ID, the time is automatically set when the first call is received.** If the time is not automatically set, follow the steps below:

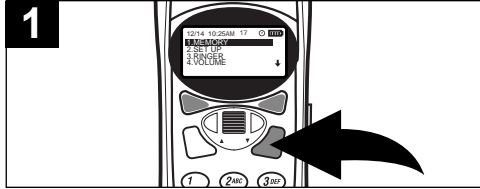

Press the MENU button; the Menu will appear in the display.

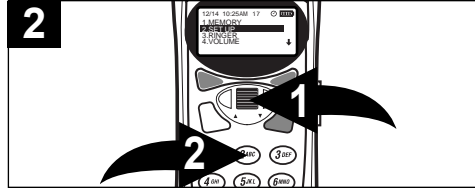

Using the CID JOG control ❶, scroll down to select "2. SET UP" and press the CID JOG control ❶, or simply press the "2" button ❷; the SET UP Menu will appear in the display.

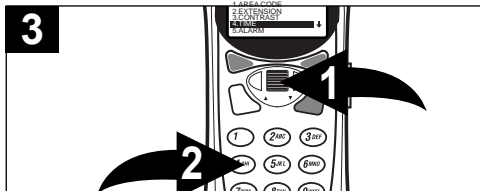

Using the CID JOG control ❶, scroll down to select "4. TIME" and press the CID JOG control ❶, or simply press the "4" button ❷; the TIME SET screen (HH:MM) will appear in the display.

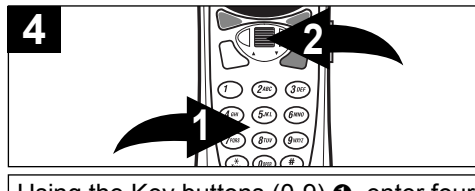

Using the Key buttons (0-9) ❶, enter four digits for the time. For example, to set the time to 9:31, press "0", "9", "3", "1", then press the CID JOG control ❷. You can also set using military time, and it will automatically convert it to AM/PM.



Using the CID JOG control, scroll to select AM or PM, then press the CID JOG control. A long beep will be heard and the time will now be set.



If a mistake is made, simply press the CLEAR button.

NOTES:

- It may take about one minute to update the time screen after the time setting.
- The time will reset to "00:00" when returned to the base, but will reset to the current time after approximately one minute.

SET-UP INSTRUCTIONS (CONTINUED)

SETTING THE AREA CODES

To conveniently call back a number from the caller ID, it is necessary to store your local area code when your telephone is installed, as follows:

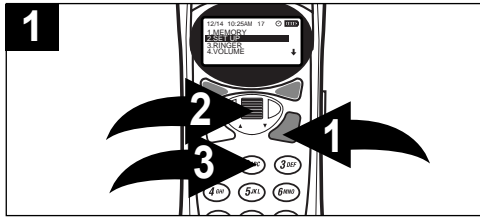

Press the MENU button ❶; the Menu will appear in the display. Using the CID JOG control ❷, scroll down to select "2. SET UP" and press the CID JOG control ❸, or simply press the "2" button ❹.

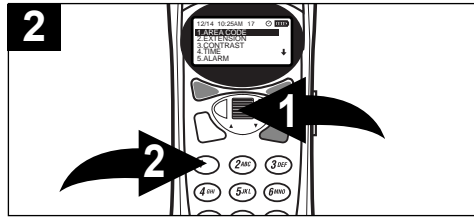

Using the CID JOG control ❶, scroll down to select "1. AREA CODE" and press the CID JOG control ❷, or simply press the "1" button ❸.

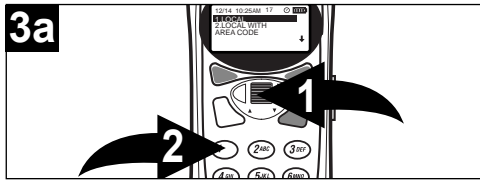

IF NOT REQUIRED TO ENTER AN AREA CODE WHEN MAKING LOCAL CALLS: Using the CID JOG control ❶, scroll down to select "1. LOCAL" and press the CID JOG control ❷, or simply press the "1" button ❸.

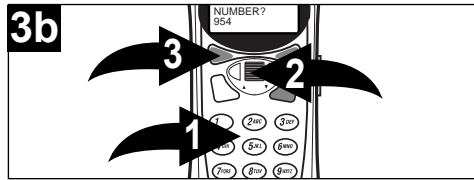

Using the Key buttons (0-9) ❶, enter your local area code and then press the CID JOG control ❷ to confirm. If a mistake is made, simply press the CLEAR button ❸.



IF REQUIRED TO ENTER AN AREA CODE WHEN MAKING LOCAL CALLS: Using the CID JOG control ❶, scroll down to select "2. LOCAL WITH AREA CODE" and press the CID JOG control ❷, or simply press the "2" button ❸; the list of codes will be displayed.

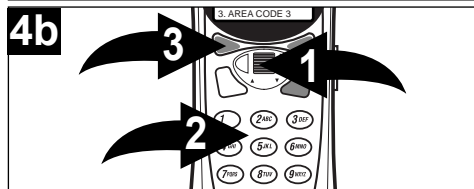

Using the CID JOG control ❶, select the desired area code(s) in your area that require 10 digit dialing (do not require the "1" prefix, but require the area code) and press the CID JOG control ❷. Using the Key buttons (0-9) ❸, enter the extra area codes in your area. If a mistake is made, simply press the CLEAR button ❹.

SET-UP INSTRUCTIONS (CONTINUED)

CHANGING THE HANDSET'S VOLUME

Change the handset's volume as follows:

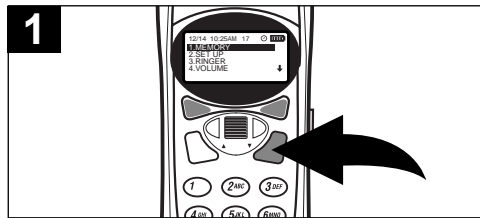

Press the MENU button; the Menu will appear in the display.

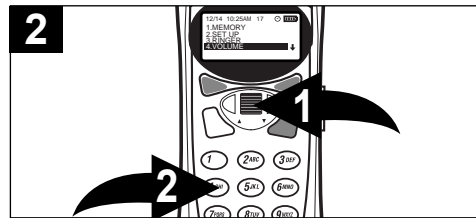

Using the CID JOG control ❶, scroll down to select "4. VOLUME" and press the CID JOG control ❶, or simply press the "4" button ❷.

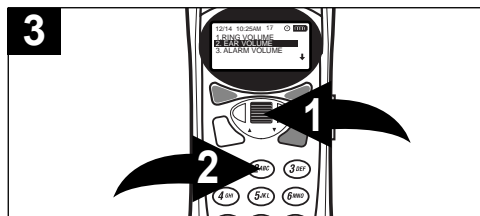

Using the CID JOG control ❶, scroll down to select "2. EAR VOLUME" and press the CID JOG control ❶, or simply press the "2" button ❷.

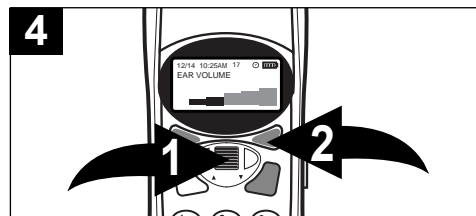

The current volume level will be displayed on the display. Use the CID JOG control ❶ to select a desired volume for the handset. Press the SEL button ❷ when finished.

OR

While you are on the phone, use the CID JOG control to change the volume.

NOTE

The factory default for the Handset's volume is 4 (the second one from the highest).

SET-UP INSTRUCTIONS (CONTINUED)

CHANGING THE RINGER VOLUME

Change the handset's ringer volume as follows:

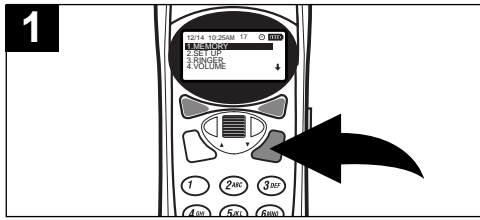

Press the MENU button; the Menu will appear in the display.

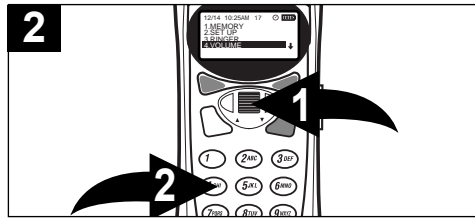

Using the CID JOG control ❶, scroll down to select "4. VOLUME" and press the CID JOG control ❶, or simply press the "4" button ❷.

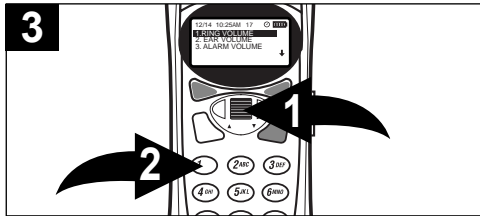

Using the CID JOG control ❶, scroll down to select "1. RING VOLUME" and press the CID JOG control ❶, or simply press the "1" button ❷.

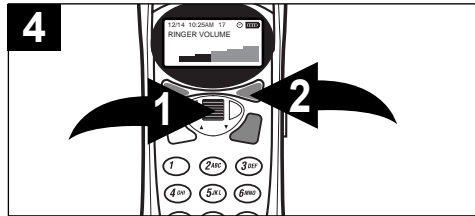

The level will be displayed on the display. Use the CID JOG control ❶ to select a desired volume for the ringer. Press the SEL button ❷ when finished.

SETTING THE CONTRAST

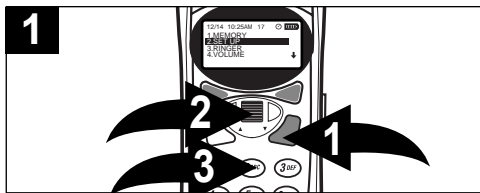

Press the MENU button ❶; the Menu will appear in the display. Using the CID JOG control ❷, scroll down to select "2. SET UP" and press the CID JOG control ❶, or simply press the "2" button ❸; the SET UP Menu will appear in the display.

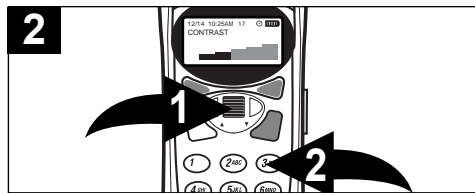

Using the CID JOG control ❶, scroll down to select "3. CONTRAST" and press the CID JOG control ❶, or simply press the "3" button ❷. Adjust the contrast using the CID JOG control ❶, then press the CID JOG control ❶ when finished.

SET-UP INSTRUCTIONS (CONTINUED)

CHANGING THE RINGER MELODY

Change the ringer melody to choose from two tones or three songs as follows:

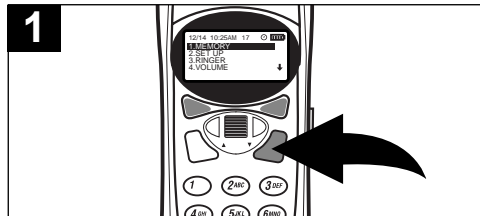

Press the MENU button; the Menu will appear in the display.

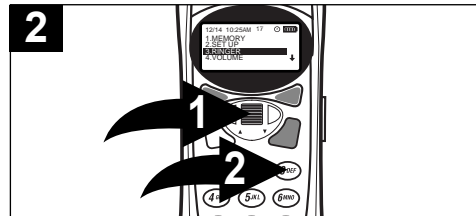

Using the CID JOG control ❶, scroll down to select "3. RINGER" and press the CID JOG control ❶, or simply press the "3" button ❷.

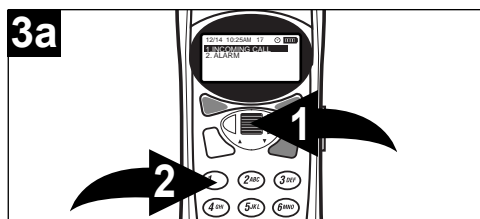

FOR THE RINGER MELODY: Using the CID JOG control ❶, scroll down to select "1. INCOMING" and press the CID JOG control ❶, or simply press the "1" button ❷.

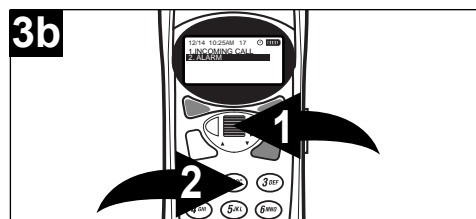

FOR THE ALARM: Using the CID JOG control ❶, scroll down to select "2. ALARM" and press the CID JOG control ❶, or simply press the "2" button ❷.

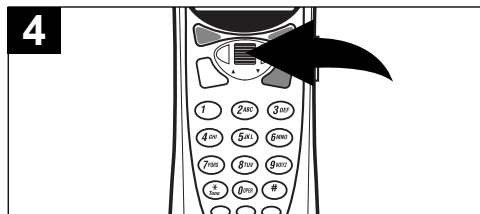

The current melody will be heard, and the melody name will be displayed on the display. Use the CID JOG control to select a desired melody for the ringer.

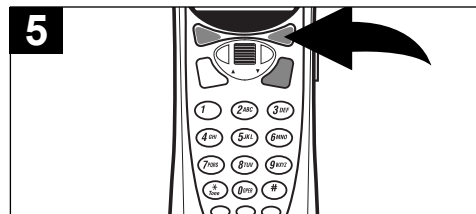

Press the SEL button when finished.

NOTE:

When you move onto the last section at the end of the manual on downloading melodies from Memorex website, you will be guided through the process of how you can access more melodies, and download them into your phone.

ADVANCED FEATURES

REGISTERING THE HANDSETS (FOR MULTIPLE HANDSET USAGE)

Make sure the battery is connected both the Main base and the HS4300BT's base are plugged in and on for at least five seconds before starting the operation. Make sure the extra headset is fully charged for normal operations. Handsets must be registered as follows (this is not necessary for the handset that comes with the main base unit):

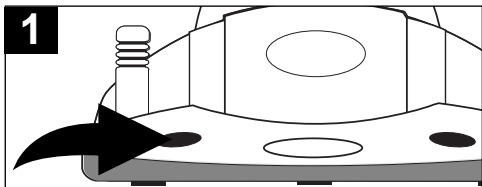

1 You can register up to seven handsets at the base. Press the PROG (Program) button on the MAIN base. The Base LED indicator will start blinking.

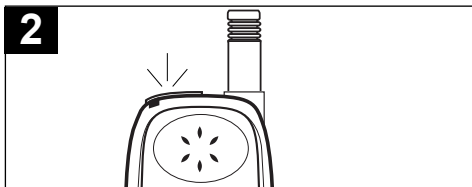

2 If the handset receives the signal, the display will show, "PROGRAMMING, PRESS SEL, PRESS PROG AGAIN" and the LED will blink.

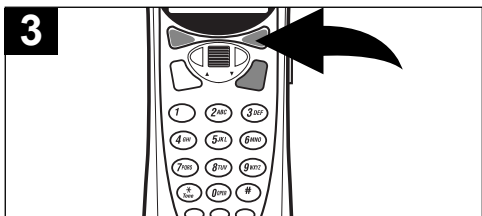

3 Within 10 seconds, press the SEL button on the handset and the PROG button on the base to confirm. If the registration was successful, the display will show "PROGRAMMED".

NOTES:

- If the operation has failed, (after a time out, etc.) an error tone will be heard.
- If Internal/Intercom Number is not assigned, the additional headset can be used to make and receive calls, but the additional features (Page, Call, Transfer, etc.) cannot be used. For Internal/Intercom Number setting, please refer to page 13.

VERY IMPORTANT:

- This extra handset must be out of the charging base in order to be programmed
- If this handset has already been programmed or if you are having problems programming the extra handset, press and hold the TRANS and "0" buttons together for two seconds ("HANDSET NOT PROGRAMMED" will appear in the display) to initialize before performing the steps above,
- If the display shows, "CONNECTING", then the handset is paired with a base, but is looking for it or cannot find it. In this case, make sure to reset the phone by following the instructions in the bullet above and try again.

ADVANCED FEATURES (CONTINUED)

ASSIGNING/CHANGING A HANDSET'S INTERNAL/INTERCOM (EXTENSION) NUMBER

The handset that comes with the unit is assigned number 1 at the factory. To assign or change the number of this handset, in order to take advantage of the additional features, simply follow the instructions below:

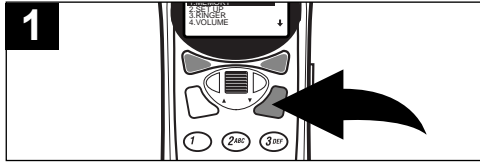

Press the MENU button; the Menu will appear in the display.

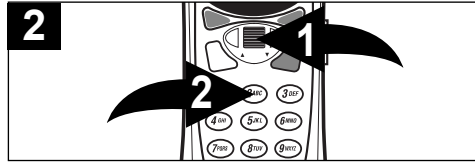

Using the CID JOG control **1**, scroll down to select "2. SET UP" and press the CID JOG control **1**, or simply press the "2" button **2**; the SET UP Menu will appear in the display.

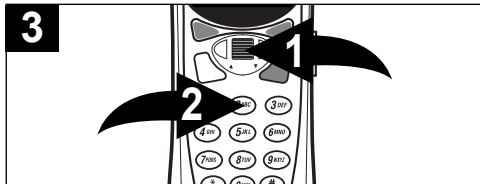

Using the CID JOG control **1**, scroll down to select "2. EXTENSION" and press the CID JOG control **1**, or simply press the "2" button **2**.

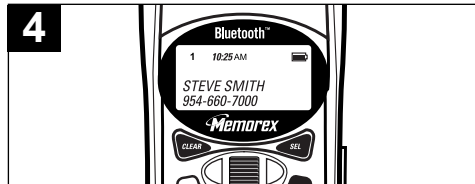

TO EDIT AN EXTENSION: Using key buttons (1-7), edit the extension number. The extension number will appear at the top left of the handset's display.

NOTE:

- The main base phone is preset at the factory to number 1. You need to program this handset to a number other than one. If the base phone is accidentally changed from the 1 setting, simply follow the instructions above to set it back to 1.

SELECT BUTTON: The SEL button can be pressed to select functions instead of pressing the CID JOG control, use the one you feel more comfortable with.

CLEAR BUTTON: Press and hold the CLEAR button to go back to the Standby mode from any other mode.

ADVANCED FEATURES (CONTINUED)

SETTING THE ALARM

THE TIME MUST BE SET BEFORE SETTING THE ALARM. (For time setting, refer to page 8.)

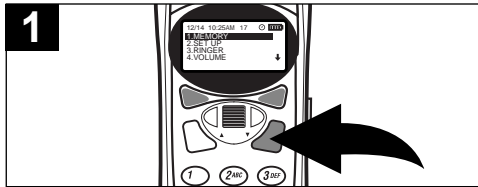

Press the MENU button; the Menu will appear in the display.

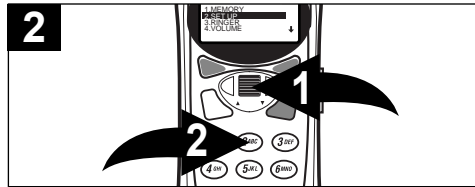

Using the CID JOG control ❶, scroll down to select "2. SET UP" and press the CID JOG control ❶, or simply press the "2" button ❷; the SET UP Menu will appear in the display.

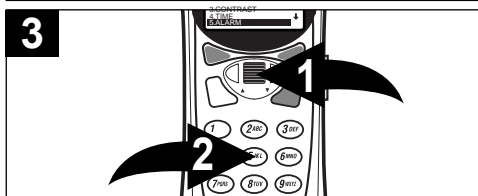

Using the CID JOG control ❶, scroll down to select "5. ALARM" and press the CID JOG control ❶, or simply press the "5" button ❷.



Using the CID JOG control, scroll down to select "ON?" and press the CID JOG control.



Using the Key buttons (0-9) ❶, enter four digits for the alarm time. For example, to set the alarm time to 7:30, press "0", "7", "3", "0", then press the CID JOG control ❷. Using the CID JOG control ❷, scroll to select AM or PM, then press the CID JOG control ❷. You can also set using military time, and it will automatically convert it to AM/PM.

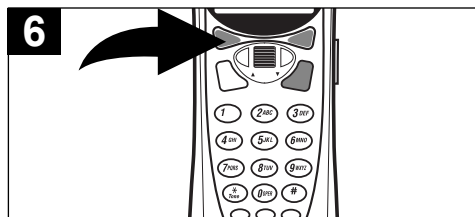

If a mistake is made, simply press the CLEAR button. When the real time matches the alarm time, the alarm will sound and the key backlight will flash for 2 minutes. Press any button on the handset to turn the alarm sound off. Repeat steps 1 through 4 to turn the alarm on again.

ADVANCED FEATURES (CONTINUED)

TURNING THE ALARM ON/OFF

After the alarm has been set, it automatically will turn on at a set time, one time only. If you would like to turn the alarm off or back on, follow the instructions below:

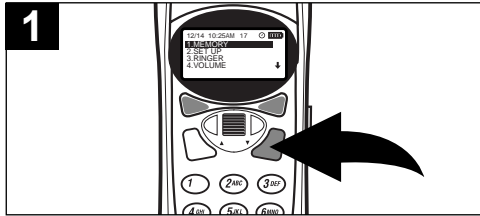

Press the MENU button; the Menu will appear in the display.



Using the CID JOG control **1**, scroll down to select "2. SET UP" and press the CID JOG control **1**, or simply press the "2" button **2**; the SET UP Menu will appear in the display.



Using the CID JOG control **1**, scroll down to select "5. ALARM" and press the CID JOG control **1**, or simply press the "5" button **2**.



Using the CID JOG control, scroll down to select "ON?" to turn the alarm on, or "OFF?" to turn the alarm off and press the CID JOG control.

When the alarm is turned on, the Alarm indicator will appear in the display. When the alarm is turned off, the Alarm indicator will disappear.

ADVANCED FEATURES (CONTINUED)

SETTING THE ALARM MELODY

Choose one of the alarm melodies as follows:

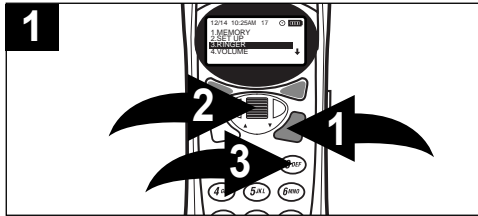

Press the MENU button **1**; the Menu will appear in the display. Using the CID JOG control **2**, scroll down to select "3. RINGER" and press the CID JOG control **2**, or simply press the "3" button **3**.

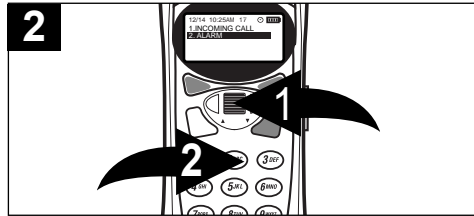

Using the CID JOG control **1**, scroll down to select "2. ALARM" and press the CID JOG control **1**, or simply press the "2" button **2**. Using the CID JOG control **1**, select a melody and then press the CID JOG control **1** to confirm.

SETTING THE ALARM VOLUME

Set the alarm volume as follows:

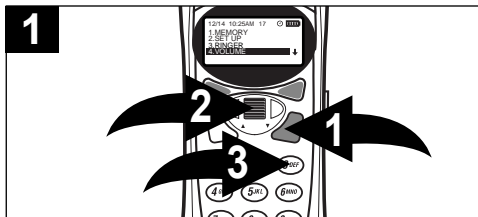

Press the MENU button **1**; the Menu will appear in the display. Using the CID JOG control **2**, scroll down to select "4. VOLUME" and press the CID JOG control **2**, or simply press the "4" button **3**.

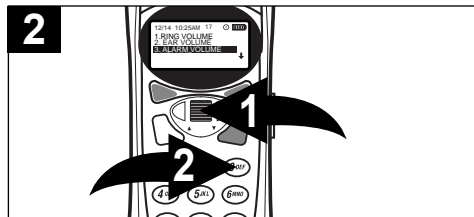

Using the CID JOG control **1**, scroll down to select "3. ALARM VOLUME" and press the CID JOG control **1**, or simply press the "3" button **2**. Using the CID JOG control **1**, change the volume and then press the CID JOG control **1** to confirm.

ADVANCED FEATURES (CONTINUED)

MAKING INTERCOM CALLS (PAGING)

Intercom calls are calls to the additional handsets and do not tie up the phone line. For example, if used in your home, you can have a conversation with your wife by the pool without going outside. Each additional handset must be registered, see page 13. Follow the instructions below for Intercom calls:

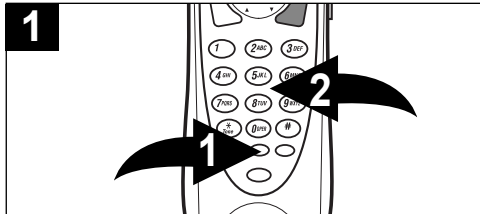

Press the PAGE button ❶ on the handset, then enter the desired handset's number using the Key buttons (1-7) ❷, "PAGING" and the extension number being paged will appear in the display.

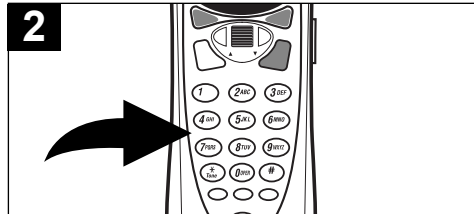

The handset(s) being paged will ring and "PAGING" and the extension number being paged will appear in the display. Press any button on the paged handset(s) to start the intercom conversation.

PAGING ALL HANDSETS

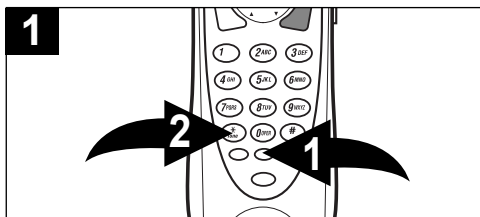

To page all handsets at once for intercom calling, press the PAGE button ❶ on the handset, then press the "*" key button ❷, "PAGING" will appear in the display.

ENDING AN INTERCOM CALL

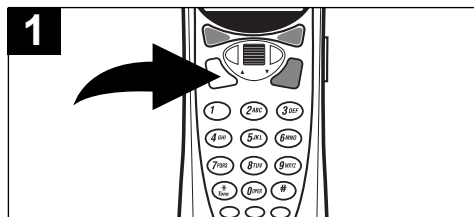

To end an intercom call, simply press the TALK button.

NOTES:

- If a call is received while using the intercom feature, simply press the FLASH button to answer the call, just like you would with call waiting. The intercom call is disconnected in this case.
- If you try to page a number that is not programmed, an error tone will be heard.

ADVANCED FEATURES (CONTINUED)

TRANSFERRING A CALL

Transfer a call to another handset (this example shows Handset 1 transferring to Handset 2) as follows:

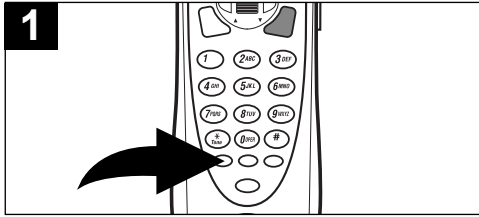

When speaking with an outside call, press the TRANS button on the handset; the party on the line will be put on hold; the display will show "TRANSFERRING ENTER EXTENSION".

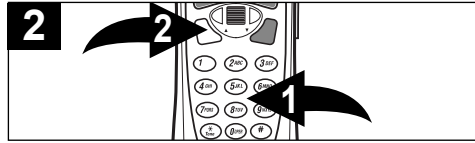

Using the Key buttons (1-7) ❶, enter the desired handset number, Handset 1 (HS1) display will show "TRANSFERRED 2". Press the TALK ❷ button on HS2 to pick up the transfer. HS1 display will then show "PAGING EX:2, PRESS FLASH FOR CONFERENCE" and HS1 and HS2 will be connected, but the outside call will be on hold. Press the TALK button ❷ on HS1 to transfer the call and hang up. If HS2 does not pick up within 30 seconds, the transfer will be cancelled.

NOTES:

- Handsets must be registered to be able to transfer a call.
- You can cancel the transfer by pressing the TRANS button again before the other handset picks up the call.

THREE WAY CONFERENCE CALLING

Use the conference call feature to be able to speak with the party who is on the phone, as well as another handset as follows:

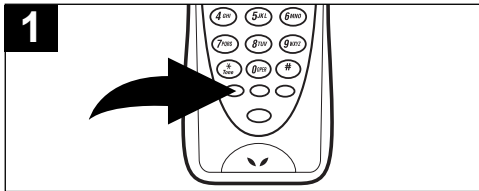

When speaking with an outside call, press the TRANS button on the handset; the party on the line will be put on hold.

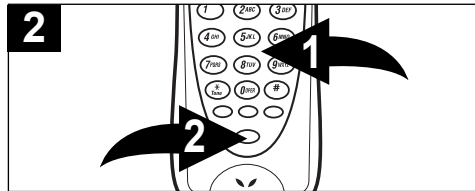

Using the Key buttons (1-7) ❶, enter the desired handset number. When the other handset picks up, press the FLASH button ❷ and both handsets, as well as the party on the line will be in conference call.

NOTES:

- Handsets must be registered to be able to use conference calling.
- Handsets are available separately.

TROUBLESHOOTING GUIDE

SYMPTOM	SOLUTION
No dial tone.	<ul style="list-style-type: none"> • Make sure the telephone line cord is connected properly to the modular wall jack.
No power on the handset.	<ul style="list-style-type: none"> • Make sure the battery pack is properly connected inside the handset. • The handset may need recharging, recharge handset.
Handset does not charge.	<ul style="list-style-type: none"> • Make sure the charging contacts on both the base and handset are in contact during charging. • The charging contacts may be dirty, clean with alcohol-moistened cloth. • The battery may not be good anymore, replace battery.
Range is limited.	<ul style="list-style-type: none"> • Move the base so it is centrally located in your residence or office and make sure the base is not located near an appliance.
Call received flutters or fades.	<ul style="list-style-type: none"> • The handset may need recharging, recharge handset.
Handset not working.	<ul style="list-style-type: none"> • These handsets are designed so if another handset is being used, the other ones cannot join the conversation, unless the call is transferred to them. • Additional handset(s) must be registered as described in this manual. • Could be a problem with the wall jack, try another one.
Cannot hear ringer.	<ul style="list-style-type: none"> • Ringer volume may be too low, raise ringer volume. • Make sure the telephone line cord is connected properly to the modular wall jack.
Caller ID information does not appear.	<ul style="list-style-type: none"> • You must subscribe to Caller ID service. • You must let the phone ring twice before answering. • Unit needs to be reset, see page 21.
Time does not automatically set.	<ul style="list-style-type: none"> • If you subscribe to Caller ID service, the time and date will automatically set during the first call. If you do not subscribe to Caller ID service, you must set manually.
Alarm does not turn on.	<ul style="list-style-type: none"> • Alarm must be set and set to on (see manual). • The time must be set before using the alarm. • The alarm volume may be too low, raise alarm volume.
Unit will not memory dial.	<ul style="list-style-type: none"> • Directories not set properly, reset as per manual. • If power is lost for a long time, the directories may be lost and need to be reprogrammed.

RESETTING THE MAIN BASE UNIT

If the handset starts to operate abnormally, or the Caller ID stops working, please unplug the MAIN BASE unit from the power source for five seconds, and then plug it back in.

CARE AND MAINTENANCE

1. Clean your phone with a damp (never wet) cloth. Solvent or detergent should never be used.
2. Avoid operating your unit under direct sunlight or in hot, humid or dusty places.
3. Keep your unit away from heating appliances.
4. Every few months, or when charging becomes abnormal, clean the contacts of the handset and the base with a standard pencil eraser.

**FOR ADDITIONAL SET-UP OR OPERATING ASSISTANCE,
PLEASE VISIT OUR WEBSITE AT WWW.MEMCORPINC.COM OR
CONTACT CUSTOMER SERVICE AT 1-800-919-3647.**

**FOR ADDITIONAL CHARGERS AND BATTERIES, CONTACT FOX
INTERNATIONAL AT 1-800-321-6993.**

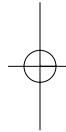
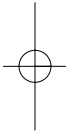

Memcorp, Inc.
Weston, FL
Printed in China

Visit our website at www.memcorpinc.com

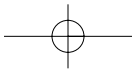



**AZURE BLUETOOTH CAPABLE
MULTI-HANDSET SYSTEM**

MODEL: HS4300BT

**BEFORE OPERATING THIS PRODUCT,
PLEASE READ THESE INSTRUCTIONS COMPLETELY.**

Multi-Handset System
Azure



OPERATING INSTRUCTIONS